

LINEA

sati *spider*

SISTEMA DI PASSERELLE
A FILO

MESH WIRE CABLE TRAYS SYSTEM



Elementi rettilinei pag. 78
Straight elements

Accessori pag. 80
Fittings

Viterie pag. 85
Screws

Per fare correre il lavoro in sicurezza

I 4 ELEMENTI CHE CARATTERIZZANO LA PASSERELLA A FILO *spider*



Sicurezza

La saldatura di testa dei fili trasversali con i fili longitudinali alti, evita il formarsi di "spuntoni" taglienti.

- *Sicurezza per l'installatore.*
- *Sicurezza per i cavi.*

Gamma

- 3 finiture: in **filo d'acciaio zincato elettroliticamente** (ZE).
in **filo d'acciaio zincato a caldo dopo lavorazione** (ZF).
in **filo d'acciaio Inox - AISI 304 (IX)** su richiesta AISI 316L.
- 3 altezze: 35 mm; 55 mm; 105 mm.
- 8 basi: da 50 mm ÷ 600 mm.

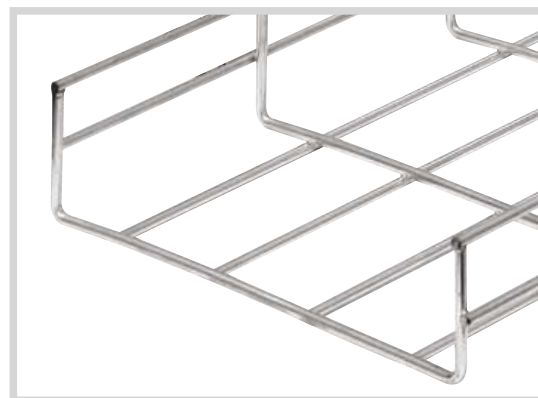

Giunzione automatica

Il nuovo Giunto Rapido Lineare - GRL assicura una veloce e robusta unione tra passerelle *spider*, senza l'utilizzo di viti ed attrezzi.

Giunzione Veloce
+
Giunzione sicura } = *Risparmio di tempo.*

Mensola *spider*

Le Mensole *spider* sono fornite di apposite feritoie nelle quali è possibile "incastrare" e fissare saldamente la passerella a filo *spider* senza l'utilizzo di viti ed attrezzi.

- *Velocità di posa.*
- *Sicurezza di aggancio.*



In order to have the work progress in total safety

The 4 elements that characterize the mesh wire cable trays *spider*



Safety

The head welding of the transversal wires with the upper longitudinal wires avoids the formation of sharp pikes.

- *Safety for the fitter.*
- *Safety for the mesh wire cable.*

Range

- 3 finishings: in **electrolitic galvanized steel wire** (ZE).
in **hot-dip galvanized steel wire after machining** (ZF).
in **stainless steel wire** - AISI 304 (IX) on request AISI 316L.
- 3 heights: 35 mm; 55 mm; 105 mm.
- 8 bases: da 50 mm ÷ 600 mm.

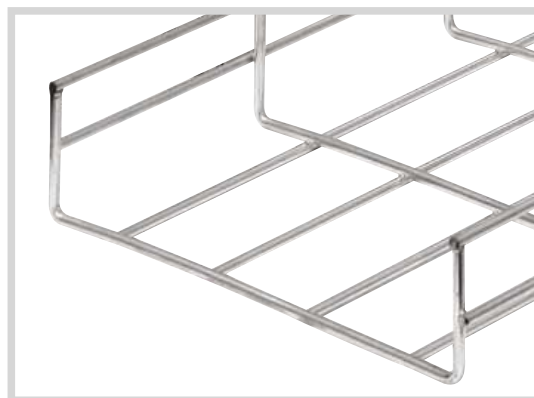

Automatic junction

The new Rapid Linear Junction – GRL ensures a rapid and strong link between the *spider* cable trays without using any screws or tools.

Rapid junction
+
Secured junction } = *Time saving*

spider bracket

The *spider* bracket are provided with appropriate slots in which the *spider* cable trays can be fitted and firmly fixed without using any screws or tools.

- *Rapid set-up.*
- *Safe hanging-up.*



SISTEMA DI PASSERELLE A FILO MESH WIRE CABLE TRAYS SYSTEM

spider

ELEMENTI RETTILINEI / STRAIGHT ELEMENTS

Passerella a filo Spider Spider mesh wire cable trays

In **filo d'acciaio zincato elettroliticamente (ZE)**.
In **filo d'acciaio zincato a caldo per immersione dopo lavorazione (ZF)**, secondo norma DIN EN ISO 1461 (CEI 7-6).
In **filo d'acciaio Inox amagnetico al Nichel-Cromo (IX)**, secondo norma DIN 1.4301 (AISI 304).
Dimensioni maglia 100 x 50 mm. In barre da 3 m.
Ordinare a parte i giunti **GSV 34 G** o **GRL** ogni barra di 3 m e per ogni altro punto di unione. Le curve orizzontali, se non già precostituite, e quelle verticali si ottengono sagomando la barra rettilinea come da esempi di montaggio. Dopo l'esecuzione di tagli ritoccare con vernice allo zinco cod. 1043981.

In **electrolitic galvanized steel wire (ZE)**.
In **hot-dip galvanized steel wire after machining (ZF)**, as per DIN EN ISO 1461 (CEI 7-6).
In **non-magnetic Nickel-Chrome stainless steel (IX)**, as per DIN 1.4301 (AISI 304).
Mesh dimension 100 x 50 mm. In 3 m bars.
Order separately the joints **GSV 34 G** or **GRL** every 3 m. Contour the straight bar as shown in the assembly examples to make horizontal, if are not used the previously assembled elbows, and vertical elbows. After cutting, touch up with liquid zinc paint Code 1043981.

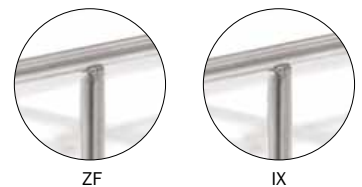
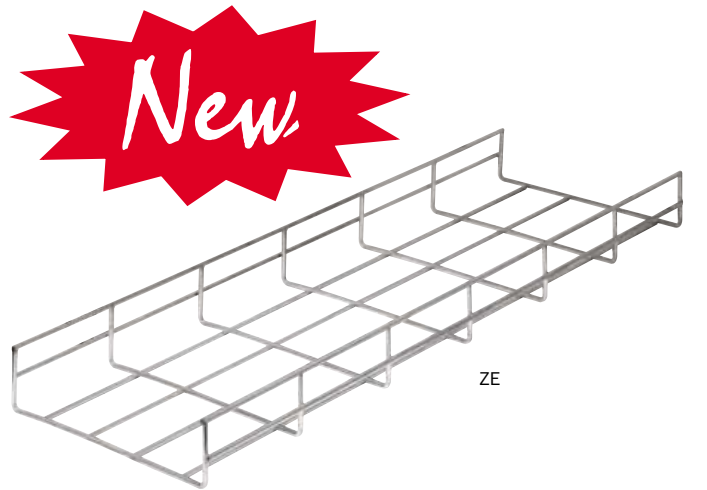

Conforme CEI EN 61537 / In according to CEI EN 61537

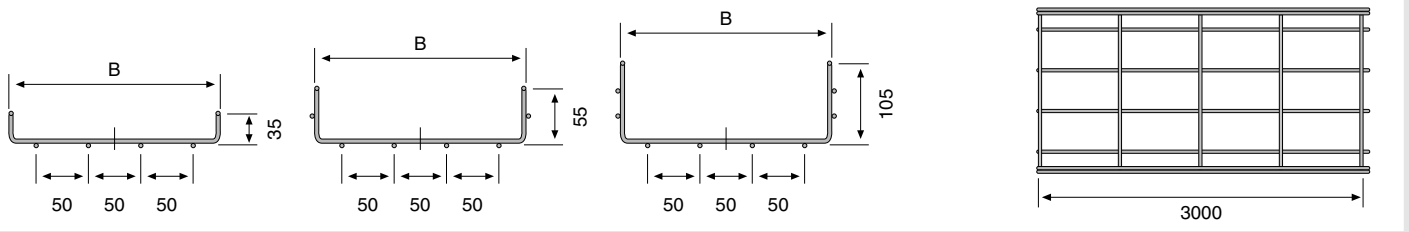

| Resistenza meccanica / Mechanical resistance | | |
|--|--|----------------------------------|
| BASE | Distanza tra gli appoggi Distance between supports m | PORTATA CAPACITY LOAD kN/m |
| SPIDER 100/55 | 1,0 | 1,10 |
| SPIDER 200/55 | 1,0 | 1,40 |
| SPIDER 500/55 | 1,0 | 1,50 |
| SPIDER 100/55 | 1,5 | 0,60 |
| SPIDER 200/55 | 1,5 | 0,70 |
| SPIDER 500/55 | 1,5 | 0,80 |
| SPIDER 200/105 | 1,0 | 0,80 |
| SPIDER 400/105 | 1,0 | 1,10 |
| SPIDER 600/105 | 1,0 | 1,25 |
| SPIDER 200/105 | 2,0 | 0,35 |
| SPIDER 400/105 | 2,0 | 0,50 |
| SPIDER 600/105 | 2,0 | 0,65 |
| SPIDER 200/105 | 3,0 | 0,25 |
| SPIDER 400/105 | 3,0 | 0,30 |
| SPIDER 600/105 | 3,0 | 0,30 |

| Lungh. Length L | Altezza Height H | Base Base B | Codice Code ZE | Codice Code ZF | Codice Code IX | Ø Filo Wire Ø | kg/m kg/m ZE-IX | kg/m kg/m ZF | Conf.m Pack.m |
|--------------------|---------------------|----------------|-------------------|-------------------|-------------------|---------------|-----------------------|--------------------|------------------|
| 3000 | 35 | 100 | 1610021 | 1640021 | 1670021 | 3,9 | 0,493 | 0,504 | 3 |
| | 35 | 150 | 1610022 | 1640022 | 1670022 | 3,9 | 0,631 | 0,645 | 3 |
| | 35 | 200 | 1610023 | 1640023 | 1670023 | 3,9 | 0,768 | 0,786 | 3 |
| | 35 | 300 | 1610024 | 1640024 | 1670024 | 4,8 | 1,591 | 1,627 | 3 |
| 3000 | 55 | 50 | 1610007 | 1640007 | 1670050 | 3,9 | 0,658 | 0,750 | 3 |
| | 55 | 100 | 1610001 | 1640001 | 1670001 | 3,9 | 0,724 | 0,774 | 3 |
| | 55 | 150 | 1610002 | 1640002 | 1670002 | 3,9 | 0,843 | 0,910 | 3 |
| | 55 | 200 | 1610003 | 1640003 | 1670003 | 4,4 | 1,286 | 1,066 | 3 |
| | 55 | 300 | 1610004 | 1640004 | 1670004 | 4,4 | 1,908 | 1,266 | 3 |
| | 55 | 400 | 1610005 | 1640005 | 1670005 | 4,8 | 2,325 | 2,193 | 3 |
| | 55 | 500 | 1610006 | 1640006 | 1670006 | 4,8 | 2,742 | 2,639 | 3 |
| | 55 | 600 | 1610008 | 1640008 | 1670008 | 4,8 | 3,130 | 3,250 | 3 |
| 3000 | 105 | 100 | 1610051 | 1640051 | 1670061 | 3,9 | 1,021 | 1,021 | 3 |
| | 105 | 150 | 1610052 | 1640052 | 1670052 | 3,9 | 1,153 | 1,153 | 3 |
| | 105 | 200 | 1610053 | 1640053 | 1670053 | 4,4 | 1,655 | 1,655 | 3 |
| | 105 | 300 | 1610054 | 1640054 | 1670054 | 4,4 | 2,393 | 2,393 | 3 |
| | 105 | 400 | 1610055 | 1640055 | 1670055 | 4,8 | 2,823 | 2,823 | 3 |
| | 105 | 500 | 1610056 | 1640056 | 1670056 | 4,8 | 3,250 | 3,085 | 3 |
| | 105 | 600 | 1610057 | 1640057 | 1670057 | 4,8 | 3,681 | 3,681 | 3 |

SISTEMA DI PASSERELLE A FILO *spider*

MESH WIRE CABLE TRAYS SYSTEM

ELEMENTI RETTILINEI / STRAIGHT ELEMENTS

Coperchio Covers

In **acciaio zincato Sendzimir (ZS)**.
 In **acciaio zincato a caldo per immersione dopo lavorazione (ZF)**.
 In **acciaio Inox - AISI 304 (IX)**.
 Si montano a scatto sulle passerelle.

In **Sendzimir galvanized steel (ZS)**
 In **hot-dip galvanized steel after machining (ZF)**.
 In **stainless steel - AISI 304 (IX)**.
 They snap onto the cable trays.



ZS



ZF

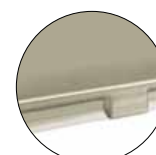

IX

| Lungh. Length L | Altezza Height H | Base Base B | Codice Code ZS | Codice Code ZF | Codice Code IX | kg/m kg/m ZS-IX | kg/m kg/m ZF | Conf.m Pack.m |
|-----------------------|------------------------|-------------------|----------------------|----------------------|----------------------|-----------------------|--------------------|------------------|
| 3000 | 15 | 50 | 1610070 | 1640070 | 1670070 | 0,370 | 0,520 | 24 |
| | 15 | 100 | 1610071 | 1640071 | 1670071 | 0,600 | 0,850 | 24 |
| | 15 | 150 | 1610072 | 1640072 | 1670072 | 0,840 | 1,180 | 24 |
| | 15 | 200 | 1610073 | 1640073 | 1670073 | 1,070 | 1,520 | 18 |
| | 15 | 300 | 1610074 | 1640074 | 1670074 | 2,060 | 2,180 | 12 |
| | 15 | 400 | 1610075 | 1640075 | 1670075 | 2,690 | 2,850 | 6 |
| | 15 | 500 | 1610076 | 1640076 | 1670076 | 3,320 | 3,510 | 6 |
| | 15 | 600 | 1610077 | 1640077 | 1670077 | 3,940 | 4,180 | 6 |

ACCESSORI / ACCESSORIES

Curva piana a 90° - CPO 90 90° horizontal elbow - CPO 90

In filo d'acciaio zincato elettroliticamente (ZE).
In acciaio zincato a caldo per immersione dopo lavorazione (ZF).

In *electrolitic galvanized steel wire* (ZE).
In *hot-dip galvanized steel after machining* (ZF).

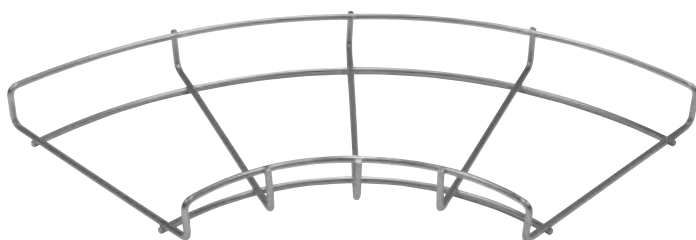

A

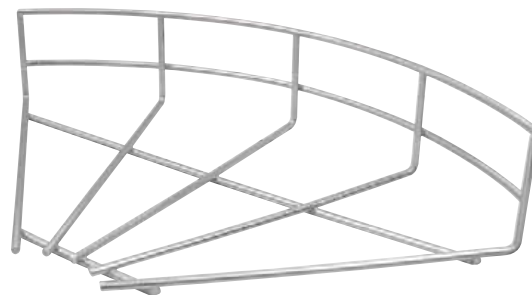

B

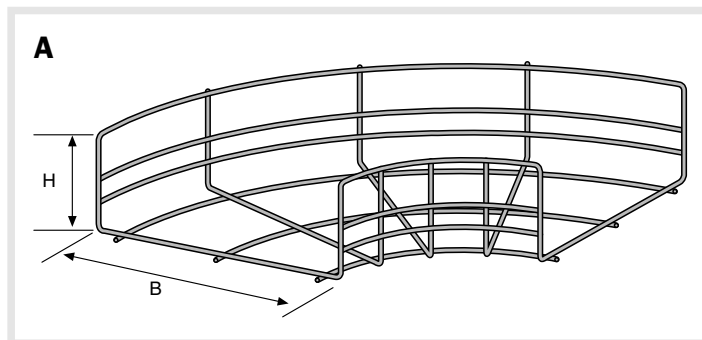

A

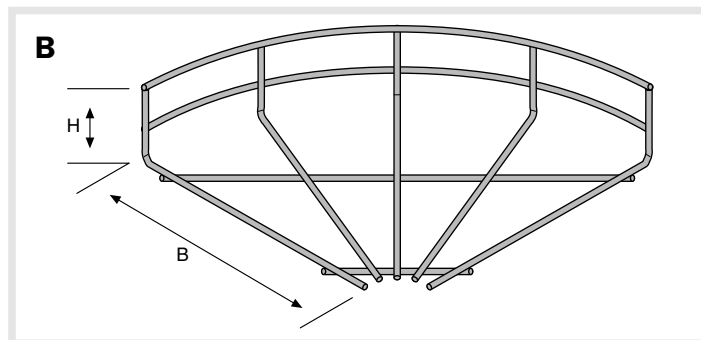

B

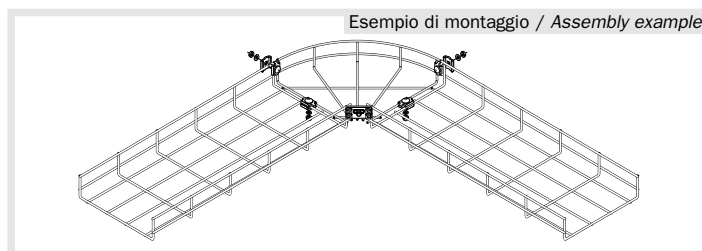

Esempio di montaggio / Assembly example

| Tipo Type | Altezza Height H | Base Base B | Codice Code ZE | Codice Code ZF | kg/pz kg/pcs | Conf.pz Pack.pcs |
|--------------|------------------------|-------------------|----------------------|----------------------|-----------------|---------------------|
| A | 55 | 100 | 1620001 | 1640111 | 0,075 | 1 |
| A | 55 | 150 | 1620002 | 1640112 | 0,160 | 1 |
| A | 55 | 200 | 1620003 | 1640113 | 0,200 | 1 |
| A | 55 | 300 | 1620004 | 1640114 | 0,450 | 1 |
| A | 55 | 400 | 1620005 | 1640115 | 0,740 | 1 |
| B | 55 | 500 | 1620006 | 1640116 | 1,020 | 1 |
| B | 55 | 600 | 1620007 | 1640117 | 1,180 | 1 |
| A | 105 | 100 | 1620111 | 1640011 | 0,100 | 1 |
| A | 105 | 150 | 1620112 | 1640012 | 0,160 | 1 |
| A | 105 | 200 | 1620113 | 1640013 | 0,282 | 1 |
| A | 105 | 300 | 1620114 | 1640014 | 0,573 | 1 |
| B | 105 | 400 | 1620115 | 1640015 | 0,737 | 1 |
| B | 105 | 500 | 1620116 | 1640016 | 1,055 | 1 |
| B | 105 | 600 | 1620117 | 1640017 | 1,248 | 1 |

SISTEMA DI PASSERELLE A FILO MESH WIRE CABLE TRAYS SYSTEM

spider

ACCESSORI / FITTINGS

Separatore - SEP Divider - SEP

In **acciaio zincato Sendzimir (ZS)**.
In **acciaio zincato a caldo per immersione dopo lavorazione (ZF)**.
In **acciaio Inox - AISI 304 (IX)**.
Asole 7 x 25 mm.
Per il fissaggio del separatore utilizzare il morsetto **GKS 34**.

In **Sendzimir galvanized steel (ZS)**.
In **hot-dip galvanized steel after machining (ZF)**.
In **stainless steel - AISI 304 (IX)**.
Slots 7 x 25 mm.
For divider fixing use **GKS 34** clamps.



Esempio di montaggio / Assembly example

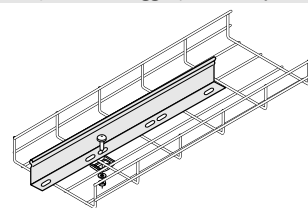
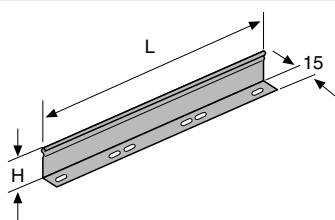

| Lungh. Length L | Altezza Height H | Codice Code ZS | Codice Code ZF | Codice Code IX | kg/m kg/m | Conf.m Pack.m |
|-----------------------|------------------------|----------------------|----------------------|----------------------|--------------|------------------|
| 3000 | 50 | 1043055 | 1743055 | 1443055 | 0,330 | 30 |
| 3000 | 100 | 1043057 | 1743057 | 1443057 | 0,590 | 30 |

Supporto per scatola di derivazione - MPG/G Boxes fixing support - MPG/G

In **acciaio zincato Sendzimir (ZS)**.
Per il fissaggio di scatole di derivazione alla passerella.
Piegarle le linguette sui fili.

In **Sendzimir galvanized steel (ZS)**.
For boxes fixing onto cable tray.
Bend the anchoring tabs on the wire.



| Codice Code ZS | kg/pz kg/pcs | Conf.pz Pack.pcs |
|----------------------|-----------------|---------------------|
| 1620452 | 0,150 | 1 |

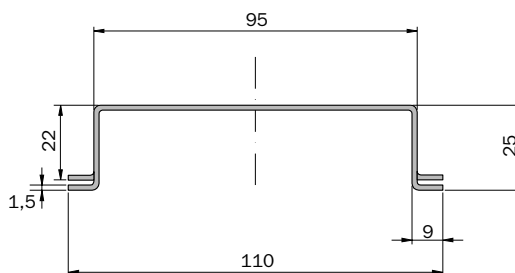
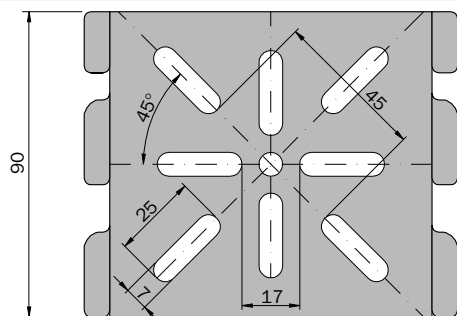

ACCESSORI / FITTINGS

Morsetto di giunzione lineare - GSV 34 G Junction plate clamp - GSV 34 G

In **acciaio zincato elettroliticamente** (ZE).
In **acciaio zincato a caldo per immersione dopo lavorazione** (ZF).
In **acciaio Inox** - AISI 304 (IX).
Completo di vite zincata M6 x 20.
Per unione lineare del fondo e delle fiancate.

In **electrolitic galvanized steel** (ZE).
In **hot-dip galvanized steel after machining** (ZF).
In **stainless steel** - AISI 304 (IX).
With galvanized screws M6 x 20.
For linear joints of bottoms and sides.



| Codice Code ZE | Codice Code ZF | Codice Code IX | kg/pz kg/pcs | Conf.pz Pack.pcs |
|----------------|----------------|----------------|--------------|------------------|
| 1620052 | 1620051 | 1670051 | 0,030 | 25 |

Esempio di montaggio / Assembly example

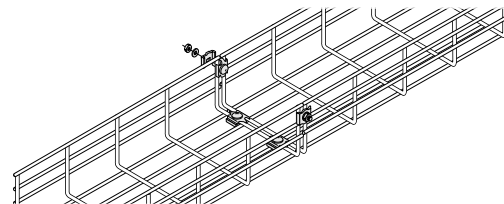
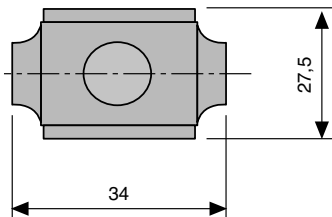

Morsetto di giunzione snodabile - GEV 36 Articulated joint clamp - GEV 36

In **acciaio zincato a caldo per immersione dopo lavorazione** (ZF).
In **acciaio Inox** - AISI 304 (IX).
Completo di vite e dado.
Per unione angolata in orizzontale; da montarsi sulle fiancate.

In **hot-dip galvanized steel after machining** (ZF).
In **stainless steel** - AISI 304 (IX).
With screws and nuts.
For angular horizontal joints to be fitted on sides.



| Codice Code ZF | Codice Code IX | kg/pz kg/pcs | Conf.pz Pack.pcs |
|----------------|----------------|--------------|------------------|
| 1620101 | 1670101 | 0,030 | 100 |

Esempio di montaggio / Assembly example

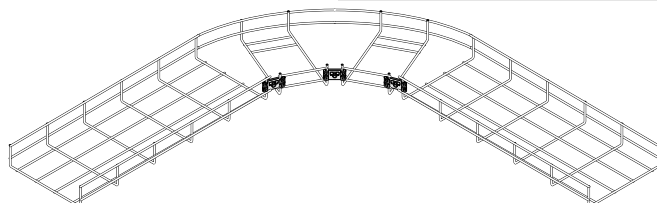
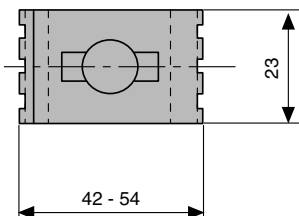

ACCESSORI / FITTINGS

Morsetto di fissaggio della passerella alle mensole e del separatore alla passerella - GKS 34 Fixing clamp for mesh wire cable trays on bracket and separator on mesh wire cable trays - GKS 34

In **acciaio zincato a caldo per immersione dopo lavorazione** (ZF).

In **acciaio Inox** - AISI 304 (IX).

Completo di vite M6 x 20.

Per il fissaggio della passerella a filo sulle mensole.

In **hot-dip galvanized steel after machining** (ZF).

In **stainless steel** - AISI 304 (IX).

With screw M6 x 20.

For mounting mesh cable tray to support brackets.



| Codice Code ZF | Codice Code IX | kg/pz kg/pcs ZF | kg/pz kg/pcs IX | Conf.pz Pack.pcs |
|----------------|----------------|-----------------|-----------------|------------------|
| 1620152 | 1670152 | 0,030 | 0,020 | 100 |

Esempio di montaggio / Assembly example

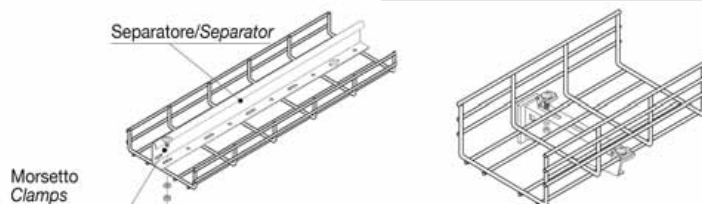
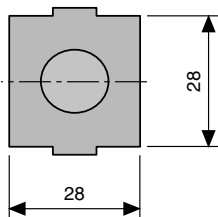

Giunto rapido lineare - GRL Linear quick joint - GRL

In **acciaio zincato Sendzimir** (ZS).

In **acciaio zincato a caldo per immersione dopo lavorazione** (ZF).

In **acciaio Inox** - AISI 304 (IX).

Collega rapidamente due passerelle Spider senza utilizzo di bulloni.

In **Sendzimir galvanized steel** (ZS).

In **hot-dip galvanized steel after machining** (ZF).

In **stainless steel** - AISI 304 (IX).

Quick joint two Spider mesh cable tray without screws.



| Codice Code ZS | Codice Code ZF | Codice Code IX | kg/pz kg/pcs | Conf.pz Pack.pcs |
|----------------|----------------|----------------|--------------|------------------|
| 1620155 | 1640155 | 1670155 | 0,070 | 10 |

Esempio di montaggio / Assembly example

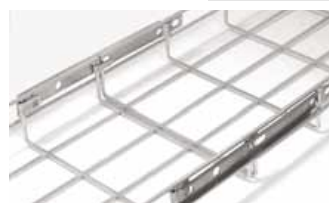

ACCESSORI / FITTINGS

Staffa distanziatrice rapida - DBL G Spacer bracket - DBL G

In **acciaio zincato Sendzimir (ZS)**.
Permette il fissaggio degli elementi rettilinei a pavimento o a parete.

In **Sendzimir galvanized steel (ZS)**.
For ceiling or wall mounting.

| Largh. passerella Mesh wire leight L | Codice Code ZS | kg/pz kg/pcs | Conf.pz Pack.pcs |
|--|----------------------|-----------------|---------------------|
| 100 | 1662100 | 0,138 | 20 |
| 200 | 1662200 | 0,209 | 20 |
| 300 | 1662300 | 0,373 | 20 |
| 400 | 1662400 | 0,467 | 20 |

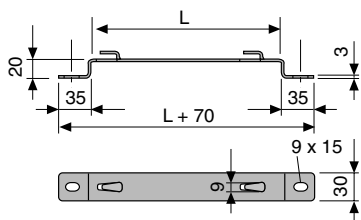
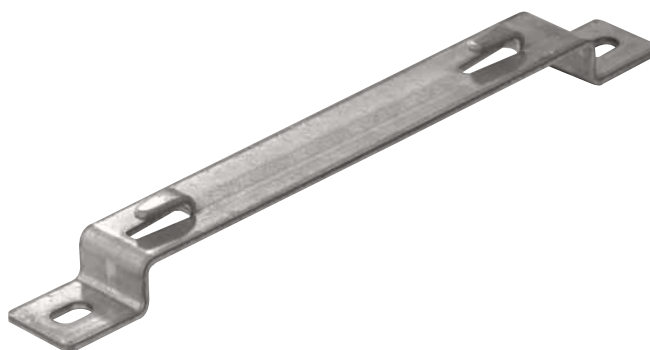

Esempio di montaggio / Assembly example

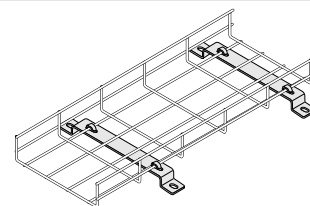

Staffa distanziatrice - DBL 50 Spacer bracket - DBL 50

In **acciaio zincato Sendzimir (ZS)**.
In **acciaio zincato a caldo per immersione dopo lavorazione (ZF)**.
Per attacco distanziale a pavimento o parete, con morsetti **GSV 34** o **GKS 50**.

In **Sendzimir galvanized steel (ZS)**.
In **hot-dip galvanized steel after machining (ZF)**.
For ceiling or wall mounting with **GSV 34** or **GKS 50** clamps.

| Base Base B | Codice Code ZS | Codice Code ZF | kg/pz kg/pcs ZS | kg/pz kg/pcs ZF | Conf.pz Pack.pcs |
|-------------------|----------------------|----------------------|-----------------------|-----------------------|---------------------|
| 100 | 1620401 | 1640401 | 0,158 | 0,160 | 20 |
| 150 | 1620402 | 1640402 | 0,193 | 0,195 | 20 |
| 200 | 1620403 | 1640403 | 0,228 | 0,230 | 20 |
| 300 | 1620404 | 1640404 | 0,380 | 0,383 | 20 |
| 400 | 1620405 | 1640405 | 0,474 | 0,477 | 20 |

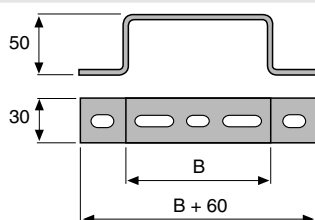

Esempio di montaggio / Assembly example

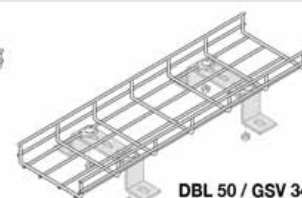
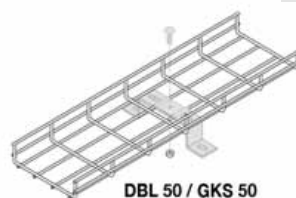

ACCESSORI / FITTINGS

Cesoia Shear

Con lame asimmetriche.
With asymmetric blades.



| Codice Code | kg/pz kg/pcs | Conf.pz Pack.pcs |
|-------------|--------------|------------------|
| 1665003 | 1,594 | 1 |

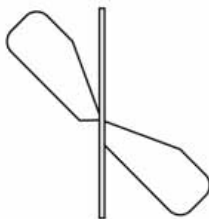

VITERIE / SCREWS

Viti Screws

Con quadro sottotesta in **acciaio zincato elettroliticamente** (ZE).
Per unire mensole Spider MS con supporto a soffitto TPS
e profilato AP 45 con staffa a soffitto K6/101.

With short square section, in **galvanized steel** (ZE).
To fixing the Spider brackets MS with ceiling support TPS
and AP 45 "U" section with ceiling support K6/101.



| Filettatura Thread | Codice Code BZE | kg/conf. kg/pack | Conf.pz Pack.pcs |
|--------------------|-----------------|------------------|------------------|
| M 8 x 30 | 2710152 | 1,720 | 100 |
| M10 x 30 | 2710202 | 2,800 | 100 |

Dadi Nuts

In **acciaio zincato elettroliticamente** (ZE), con zigrinatura
antiallentamento.

In **galvanized steel** (ZE), with antiloosening knurling.



| Filettatura Thread | Codice Code BZE | kg/conf. kg/pack | Conf.pz Pack.pcs |
|--------------------|-----------------|------------------|------------------|
| M 8 | 2710502 | 0,730 | 100 |
| M10 | 2710503 | 1,190 | 100 |

Viti Screws

Con quadro sottotesta. **Completa di dado con zigrinatura
antiallentamento.**

With short square section. **Complete of nuts with antiloosening
knurling.**



| Filettatura Thread | Codice Code BZF | kg/conf. kg/pack | Conf.pz Pack.pcs |
|--------------------|-----------------|------------------|------------------|
| M6 x 15 | 2720551 | 0,520 | 100 |